

4

3

2

1

THESE DRAWINGS AND SPECIFICATIONS ARE THE PROPERTY OF JBL INCORPORATED. THEY ARE ISSUED IN STRICT CONFIDENCE AND SHALL NOT BE REPRODUCED OR USED AS THE BASIS FOR MANUFACTURE OR APPARATUS WITHOUT WRITTEN PERMISSION.

ALL MATERIAL SPECIFIED ON THIS DRAWING SHALL CONTINUALLY COMPLY WITH THE EFFECTIVE EU RoHS DIRECTIVE, CURRENTLY 2011/65/EU, INCLUDING ALL AMENDMENTS.

REVISIONS			
LTR	DESCRIPTION	DRFT	DATE
A	INITIAL RELEASE	CH	3/10/26

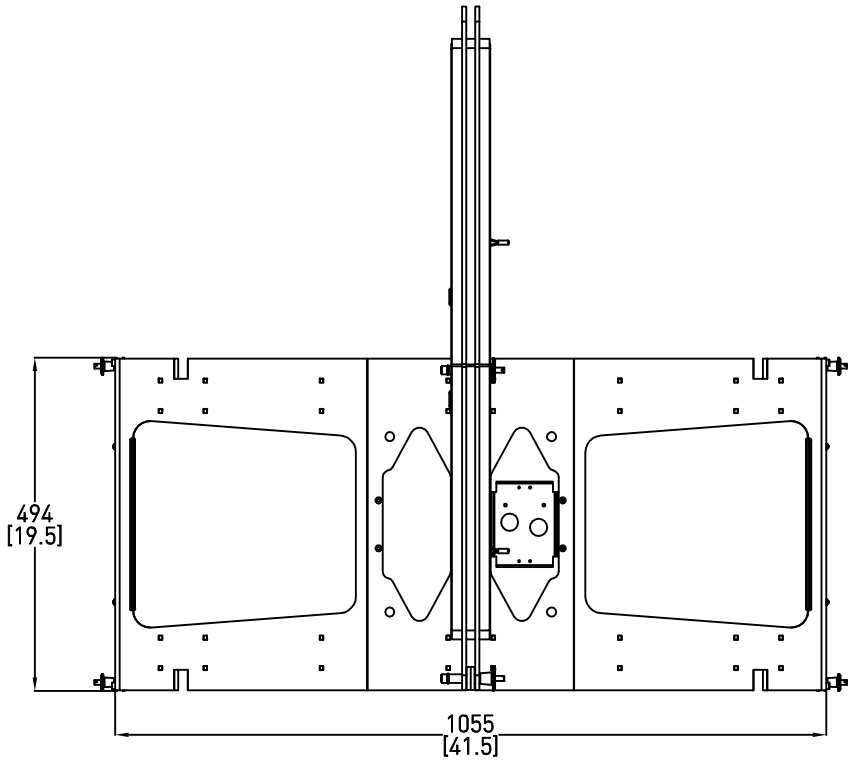

TOP

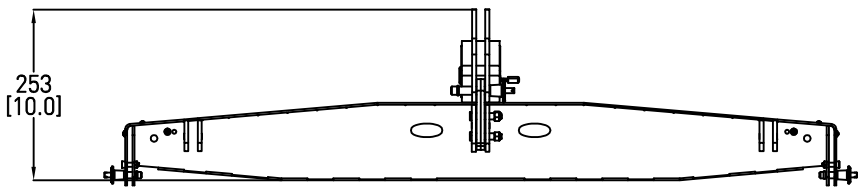
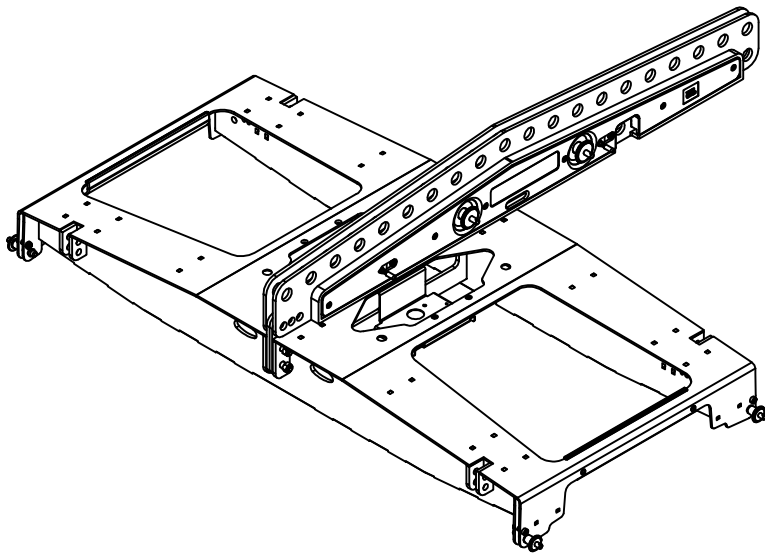

FRONT

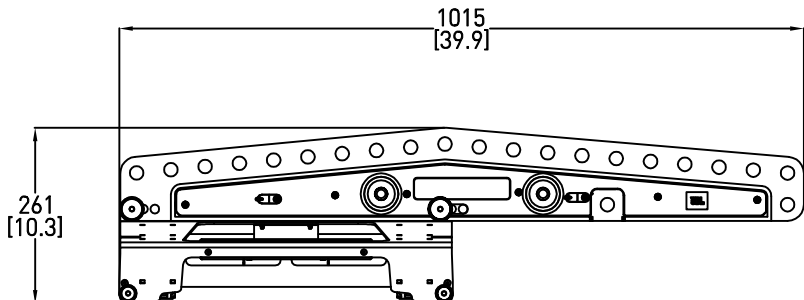

LEFT/RIGHT

4. SHOWN WITH EXTENSION BAR EXTENDED TO THE REAR, THE EXTENSION BAR CAN EXTEND TO THE FRONT OR THE REAR OF THE FRAME TO ACCOMMODATE BOTH TILT UP OR TILT DOWN OPTIONS.
3. MATERIALS: HIGH GRADE STEEL WITH ANTI-CORROSION COATING
2. WEIGHT: 44.0 KG(97 LB)
1. FINISH: BLACK POWDERCOAT

NOTES: (UNLESS OTHERWISE SPECIFIED)

TOLERANCES

(UNLESS OTHERWISE SPECIFIED)

X.XX ± .063 INCH

XX ± .125 INCH

ANGULAR TOLERANCE OF 0°±30°

FRACTIONAL DIMENSIONS ± 1/32

\* DIMENSIONS ARE IN MM (INCHES)

\* ALL DIMENSIONS ARE FINISHED DIMENSIONS

\* DO NOT SCALE DRAWING

**HARMAN**

JBL Professional  
8500 Balboa Blvd  
Northridge, CA 91329  
USA

TITLE  
CUSTOMER DRAWING,VTX A12 AF MKII

SIZE **A** DRAWING NO. 1000388971 REV **A**

SCALE NTS SHEET 1 OF 1